

SentraCath IV Safety Cannula

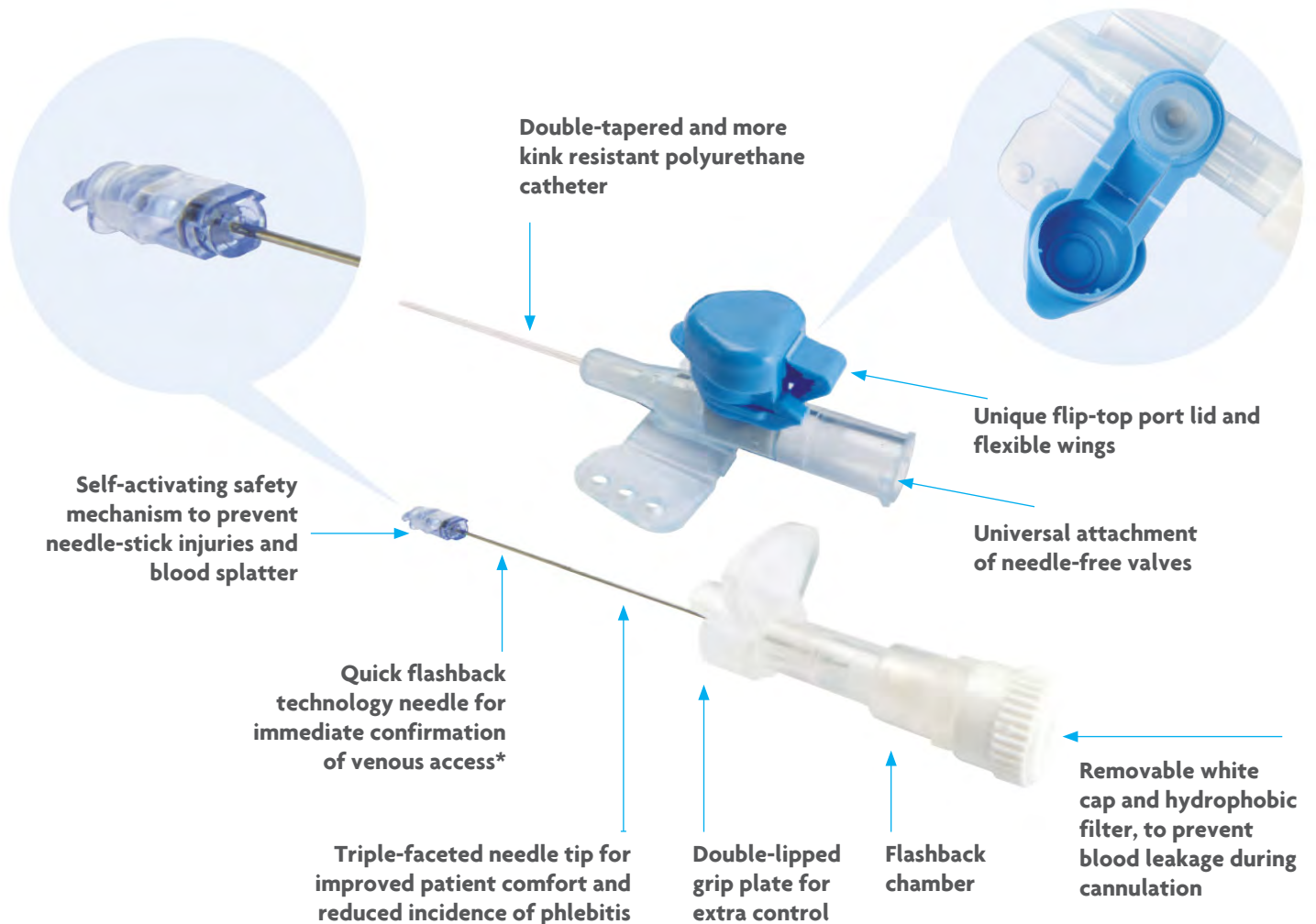

- 
- Flashback needle to confirm venepuncture
 - Thin-walled needle
 - Robust safety clip
 - Minimal withdrawal resistance and activation force required
 - Reduced risk of dislodgement

SentraFlex IV Safety Cannula - ported and winged



*ADVA – Quick flashback technology needles available in 18G, 20G, 22G, 24G, 26G

Product code	Size	Catheter ID/OD (mm)	Catheter length (mm)	Flow rate (ml/min)	NHS Supply Chain code
A/1101/14/P	14G	1.7/2.1	45	305	FSP5044
A/1101/16/P	16G	1.3/1.7	45	200	FSP5049
A/1101/18/P	18G	0.9/1.3	45/32	95	FSN85071
A/1101/20/P	20G	0.8/1.1	32	65	FSN85073
A/1101/22/P	22G	0.6/0.9	25	36	FSN85072
A/1101/24/P	24G	0.5/0.7	19	23	FSN85070
A/1101/26/F	26G	0.45/0.6	19	17	FSP5050

SentraCan IV Safety Cannula – winged

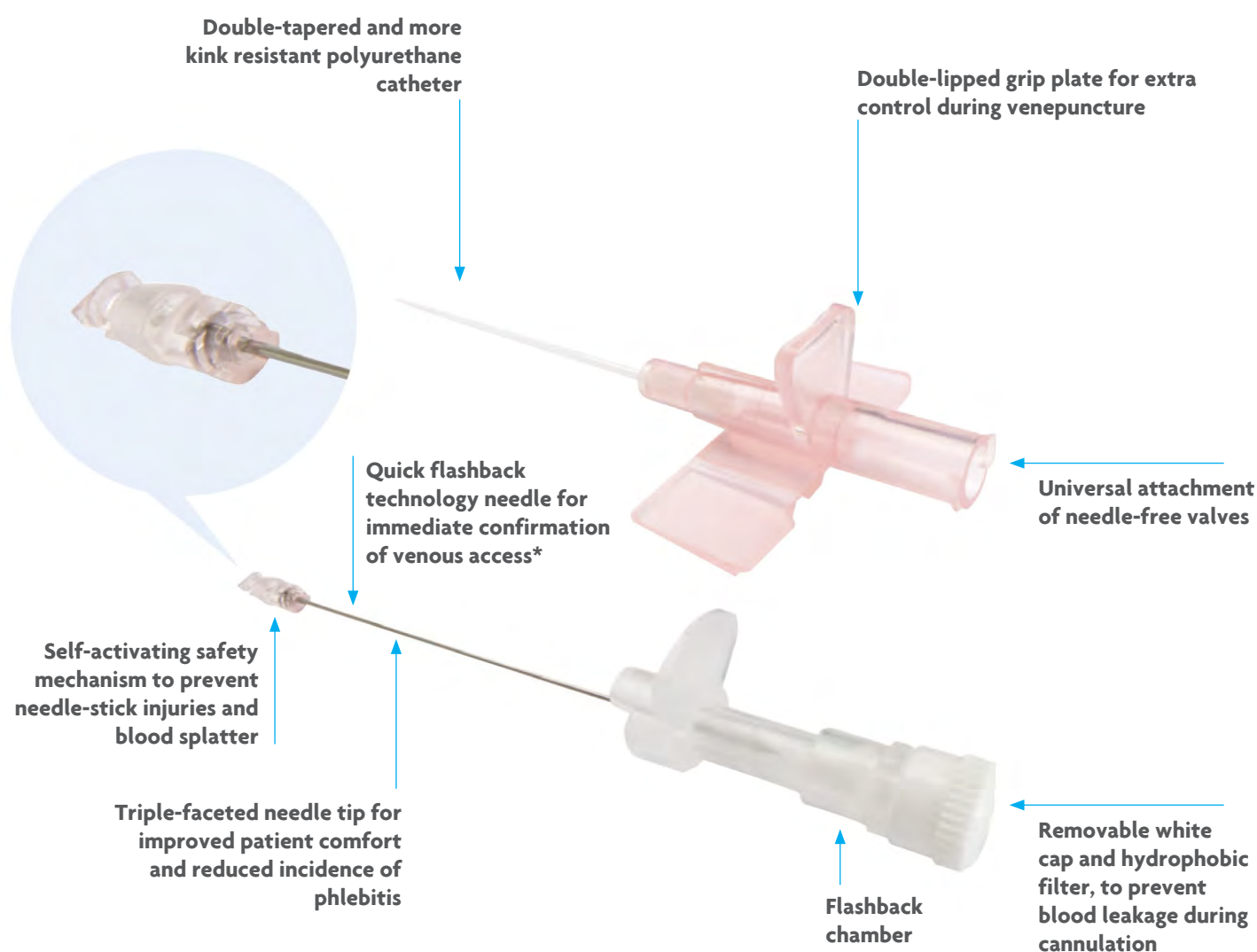

*ADVA – Quick flashback technology needles available in 18G, 20G, 22G, 24G, 26G

Product code	Size	Catheter ID/OD (mm)	Catheter length (mm)	Flow rate (ml/min)	NHS Supply Chain code
A/1114/14/P	14G	1.7/2.1	45	305	FSP5055
A/1114/16/P	16G	1.3/1.7	45	200	FSP5051
A/1114/18/P	18G	0.9/1.3	45/32	95	FSP5059
A/1114/20/P	20G	0.8/1.1	32	65	FSP85234
A/1114/22/P	22G	0.6/0.9	25	36	FSP85235
A/1114/24/P	24G	0.5/0.7	19	23	FSP85233
A/1114/26/F	26G	0.45/0.6	19	17	FSP5065

SentraWin IV Safety Cannula

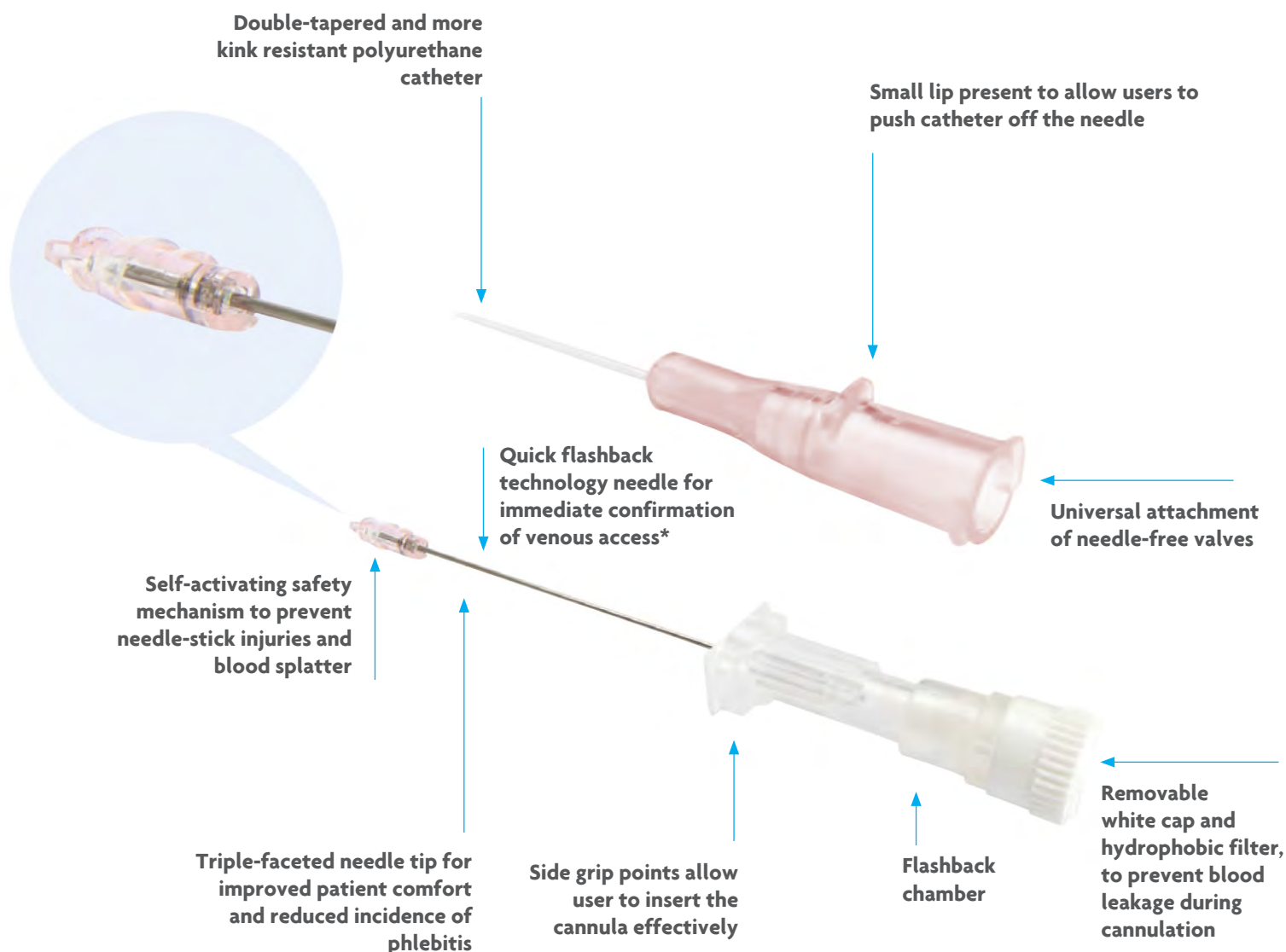

*ADVA – Quick flashback technology needles available in 18G, 20G, 22G, 24G, 26G

Product code	Size	Catheter ID/OD (mm)	Catheter length (mm)	Flow rate (ml/min)	NHS Supply Chain code
A/1103/14/P	14G	1.7/2.1	45	305	FSP5060
A/1103/16/P	16G	1.3/1.7	45	200	FSP5066
A/1103/18/P	18G	0.9/1.3	45/32	95	FSP5045
A/1103/20/P	20G	0.8/1.1	32	65	FSP5062
A/1103/22/P	22G	0.6/0.9	25	36	FSP85236
A/1103/24/P	24G	0.5/0.7	19	23	FSP85237
A/1103/26/F	26G	0.45/0.6	19	17	FSP5046